

## LISTA DE RECAMBIOS / LIST OF SPARES

Nº de parte Item No.	Descripción Description	2684 2684D 2685	BC DCE AC TBN
1	Caja eléctrica Electric box	ER2682/01	
2	Pantógrafo Pantograph	ER7609	
3	Set de aislantes pantógrafo Pantograph insulators set	ER26002	
4	Set de argollas techo Roof rings set	ER2684/04	
5	Salida de aire Air exhaust	ER2682/05	
6	Set de asideros techo Roof hand holds set	ER2682/06	
7	Enchufes frontales Front part plugs	ER2682/07	
8	Bocina Horn	ER2682/08	
9	Foco Front lighting	ER6906/01	
10	Ventana frontal derecha Right front window	ER6909/01	
11	Ventana frontal izquierda Left front window	ER6910/01	
12	Set asideros inferiores Bottom hand holds set	ER2682/12	
13	Asidero frontal Front hand hold	ER2682/13	
14	Set de pasamanos Handrail set	ER2682/14	
15	Set de aislantes cable Wires isolators set	ER2684/15	
16	Carcasa Bodyshell	ER2684/16	
17	Cristales laterales Side part windows	ER2684/17	
18	Cabina completa Complete cabin	ER6912	
19	Maquinista Driver	ER34074	
20	Set de tornillo pantógrafo Pantograph screw set	ER6907A	
21	Contacto pantógrafo Contact pantograph	ER6908	
22	Circuito impreso Printed circuit	ER2682/22	
23	Led blanco dorado Golden white led	ER6961	
24	Led rojo Red led	ER6962	
25	Separador Spacer	ER6960	
26	Tornillo circuito impreso Printed circuit screw	ER6914	
27	Set conjunto luces Lighting set	ER6963	
28	Motor Motor	ER6918	
29	Cardan Cardan joint	ER6919	
30	Bloque bastidor Main frame	ER2682/30	
31	Chasis perimetral Perimeter frame	ER2684/31	

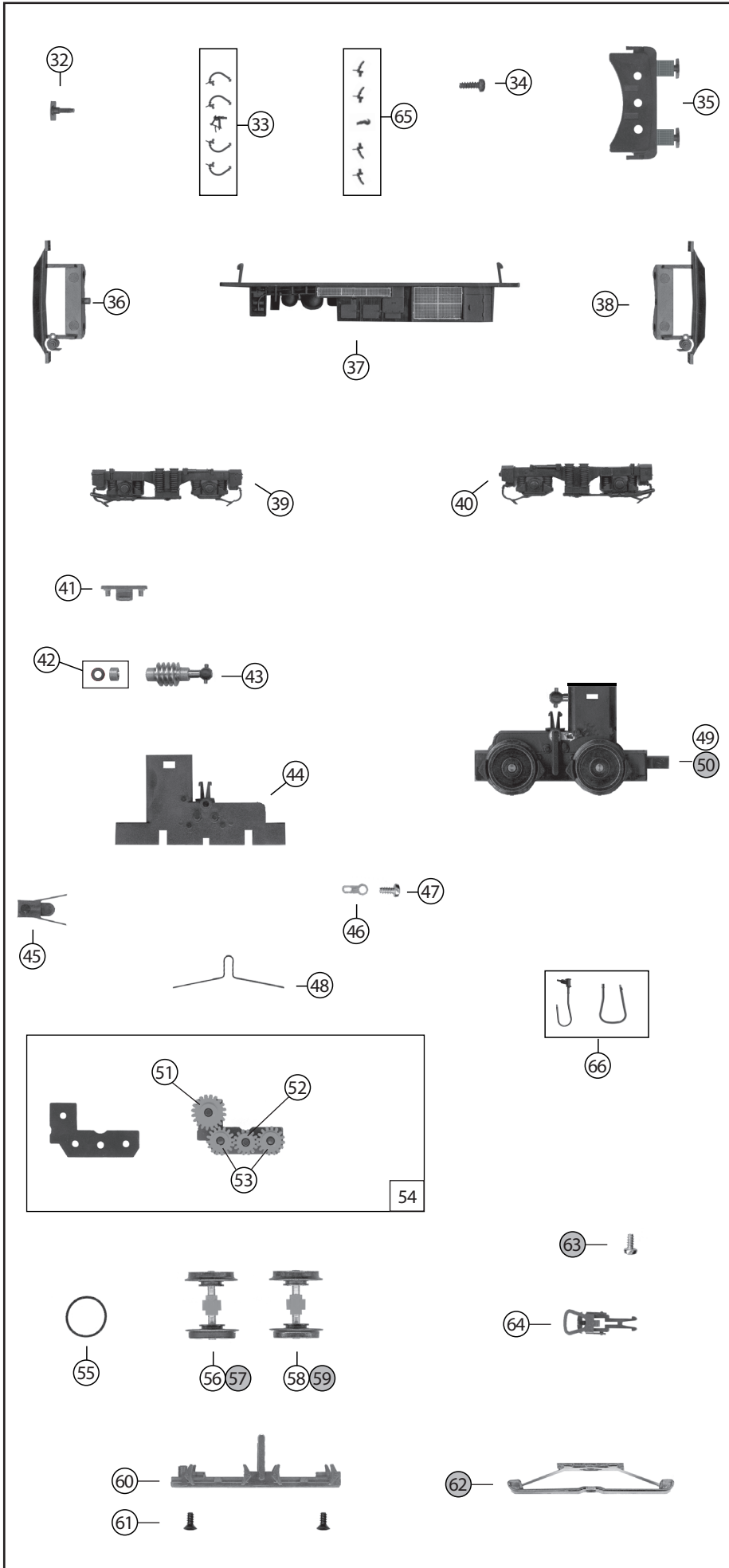

## LISTA DE RECAMBIOS / LIST OF SPARES

Nº de parte Item No.	Descripción Description	2684 2684D 2685	DC AC
32	Tope Buffer	ER6925/01	
33	Set mangueras decorativas Decorative hoses set	ER2684/33	
34	Tornillo topera Buffers holder screw	ER6914	
35	Topera Buffers holder	ER2684/35	
36	Quitanieves extremo 2 Extreme snowplough 2	ER6928/01	
37	Timonería Under-frame accessories	ER2684/37	
38	Quitanieves extremo 1 Extreme snowplough 1	ER6929/01	
39	Cobertura bogie 2 Bogie shell 2	ER6931/01	
40	Cobertura bogie 1 Bogie shell 1	ER6932/01	
41	Tapa sinfin Gear worm lid	ER6933	
42	Cojinete sinfin Worm gear bearing	ER6935	
43	Sinfin Gear worm	ER6934	
44	Caja de engranajes Gear box	ER6936/01	
45	Porta enganches Coupling holder	ER6937/01	
46	Terminal Terminal	ER6938	
47	Tornillo Screw	ER6939	
48	Contacto ruedas Wheel current pick up	ER6940	
49	Bogie completo DC Complete DC bogie	ER6945/01	
50	Bogie completo AC Complete AC bogie	ER6969/01	
51	Engranaje Gear	ER6942	
52	Engranaje Gear	ER6944	
53	Engranaje Gear	ER6943	
54	Conjunto de transmisión Transmission set	ER6941	
55	Aro de adherencia Traction Tyre	ER6946	
56	Rueda con aro DC Wheelset with tyre DC	ER6947	
57	Rueda con aro AC Wheelset with tyre AC	ER6948	
58	Rueda sin aro DC Wheelset withouth tyre DC	ER6949	
59	Rueda sin aro AC Wheelset withouth tyre AC	ER6950	
60	Base bogie Bogie base	ER6951/01	
61	Tornillo base bogie Bogie bottom screw	ER6965	
62	Patín de contacto AC AC Pick up Shoe	ER6952	
63	Tornillo patín Pick up Shoe screw	ER6953	
64	Enganche Coupling	ER058	
65	Set mangueras funcionales Functional Set hoses	ER2684/65	
66	Mangueras Hoses	ER2684/66	
67	Bolsa de accesorios Accessories bag	ER2684/67	